

Phase I

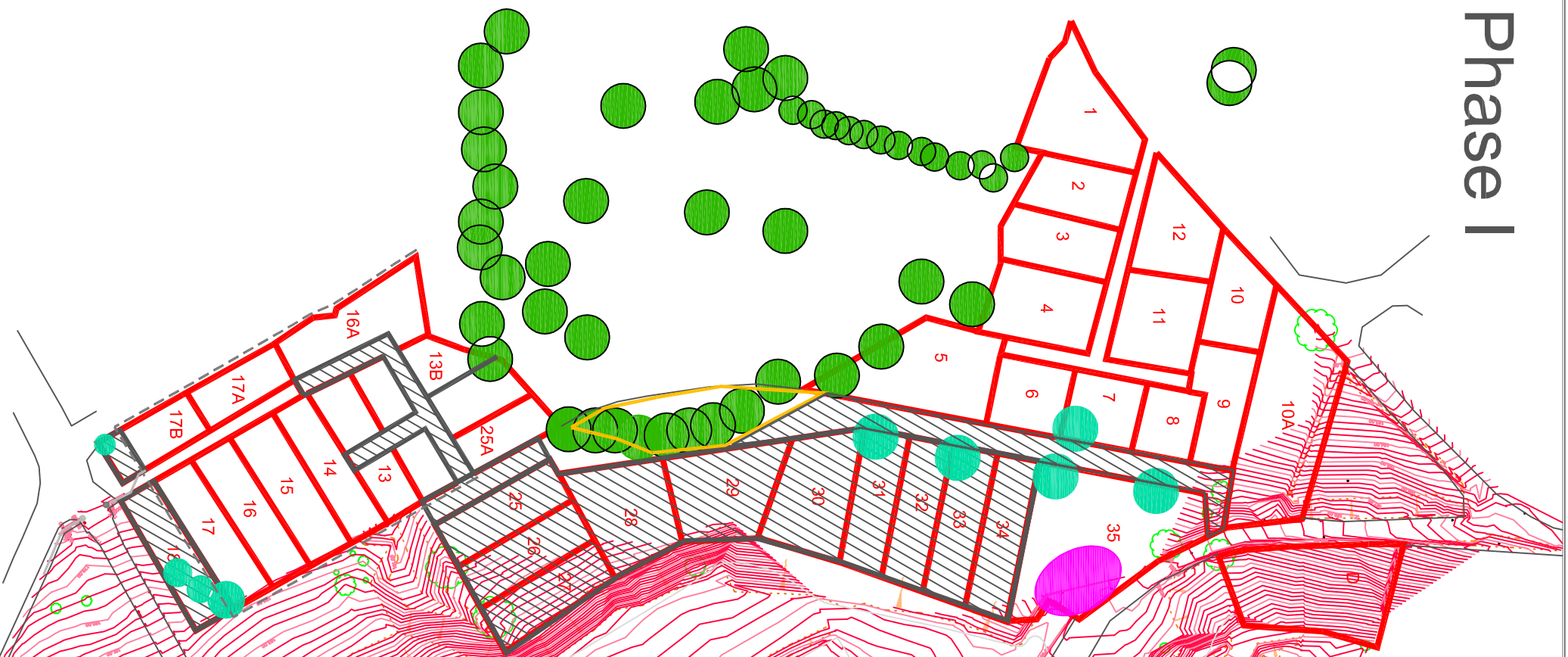

Phase II

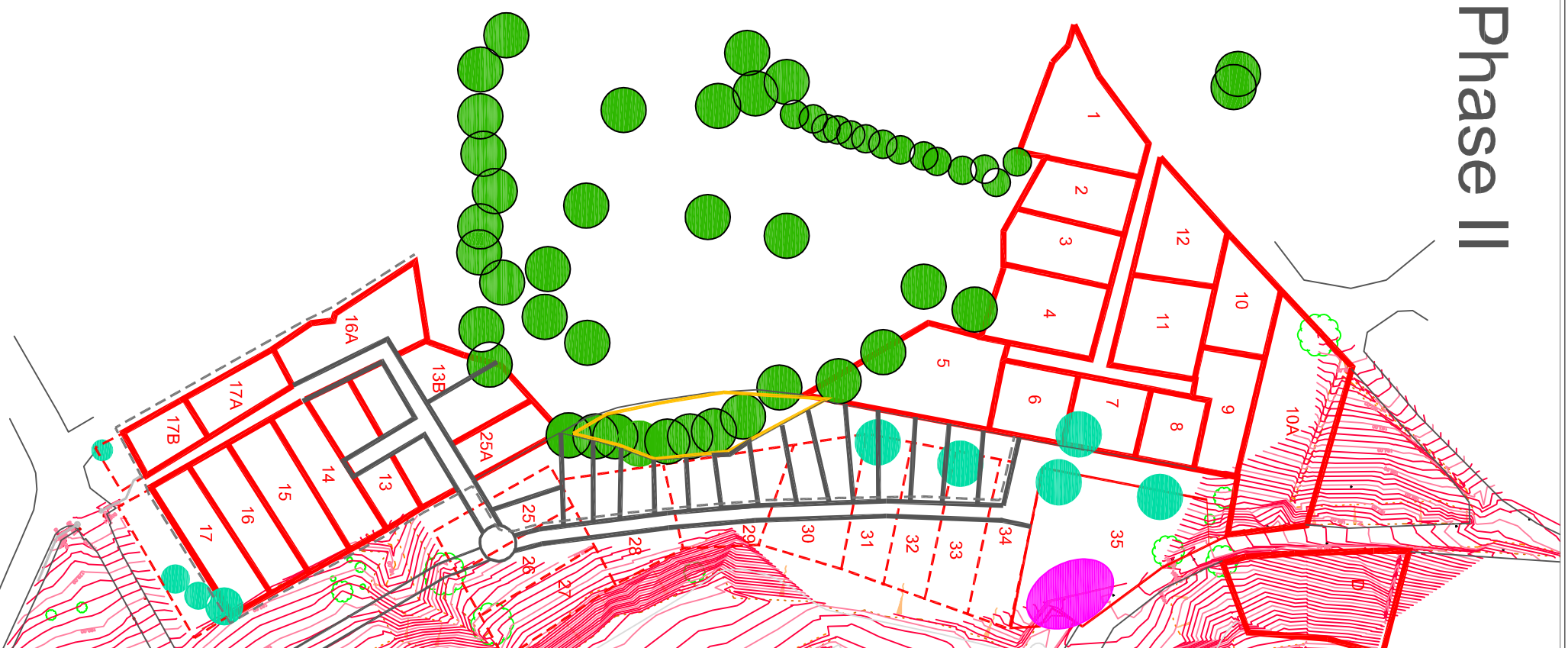



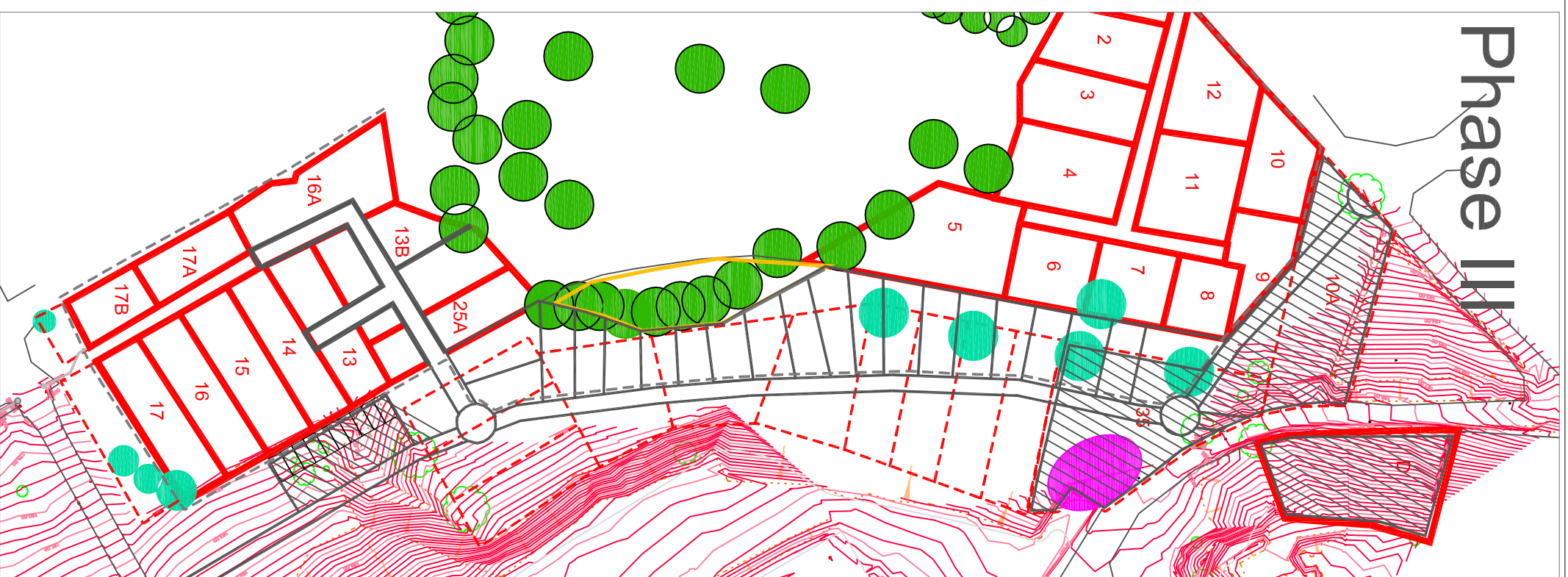









Phase III



Notes
 1) Figures dimensions to be taken. Do not scale dimensions. Contractors must verify all dimensions on site before preparing shop drawings or commencing any work.
 2) Copyright ©. This drawing must not be reproduced without the permission of Groundwork Pennine Lancashire
 3) Reproduced from 1986 Ordnance Survey mapping with permission of the controller of HMSO.

KEY

-  Existing allotments including numbers
-  TPO trees
-  Other large trees
-  Old plots and debris to be removed
-  Landowner - Morris Homes
-  Japanese Knotweed treatment
-  New secure boundary fencing
-  New paths and vistas
-  Original boundary to allotments
-  Parking
-  Improved entrance from Avenue Parade
-  Available Contour Information

DATE	REVISION NOTES	ISSUE	CHKD

GROUNDWORK PENNINE LANCASHIRE
 Bob Watts Building,
 Nova Scotia Wharf
 Bolton Rd, Blackburn
 Lancs BB2 3GE
 Tel 01294 265163
 email: pennine@groundwork.org.uk
 www.groundwork.org.uk

CLIENT
 Hyndburn Borough Council
PROJECT
 Peel Park Allotments

TITLE
 1 Peel Allotment Phasing - Draft

SCALE
 Not to scale

DATE
 9.11.10

DRAWING NO.
 SC7047/SK011

DRAWN BY
 AD

CHECKED BY
 SC7/047

PROJECT CODE
 SC7/047

ISSUE
 AD